

# Focus on Baring Head/Orua-Pouanui

*Restoring our past, revealing our history*

2017



The Friends of Baring Head Trust and Greater Wellington Regional Council are working together to redevelop the lighthouse keeper's complex at Baring Head in East Harbour Regional Park. The buildings and compound are historically significant because they are the only remaining lighthouse complex in original condition in New Zealand. Works proposed will create an attractive new destination for visitors close to Wellington. Work on restoration will take place through a range of projects and we are calling on people, businesses and others to get involved.

## Project 5. Restoring the Shelter Belt

Baring Head is a windy place. In fact the NIWA weather station here records over 72 days a year when the wind gusts exceed 96 km/hr, and 255 days when with gusts over 63 km/hr. Imagine the light keepers living here in these winds – and trying to establish and maintain vegetation for shelter from the wind. Hardy people and plant species are required. Historic photographs show the lighthouse complex first with Manuka brush fences, then a thick row of macrocarpa. **Help us to restore the vegetation shelter belt around the lighthouse complex, removing dead wood and replanting with a mixture of exotic and native species.**

### Why?

Over time some macrocarpa have died and others are in senescence; slowly deteriorating - and letting the wind through. Restoring the wind breaks and replanting is part of an overall restoration plan for the cottages, outbuildings and garden area of the light house complex. It's a critical thing to do - so other plantings in the garden area can survive the winds. Restoring the shelter belt will also create habitat for lizards, birds and other species.

### How you can help

- Bring your muscle and effort to help clean up the wind breaks
- Help fund and install temporary wind break fencing in gaps in the hedge row
- Plant new vegetation for wind break and habitat purposes
- Come along to other working bees organised by the Friends – there is lots more work to be done to restore the gardens, plant native species and restore habitat for native animals



The shelter belt fence needs replacing and missing vegetation restored.



The lighthouse and lightkeeper's cottages in the 1940s before trees were established with the assistance of wind sheltering fences.

It's still a windy place but made calmer by the shelter belt which also provides habitat for wildlife and birds.



Gaps in the shelter belt need to be replanted, supported by windbreak fencing until plants establish in this exposed location.

# Benefits for you/ your organisation

- Recognition on sponsor's panel in Powerhouse Visitor Centre
- Your company name on the new fences
- Your company associated with a beautiful and special place
- Make a big difference to how the complex looks and feels
- Be part of a community-led project
- Be part of the first stage of redevelopment
- Promote your community work

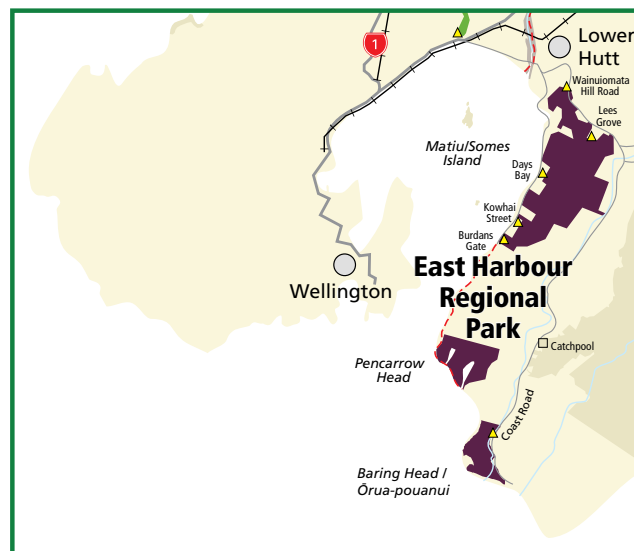

## Estimated funds required - \$15k

### Our cost estimates include:

- New shelter belt brush fencing strong enough to withstand Baring Head's gale force winds

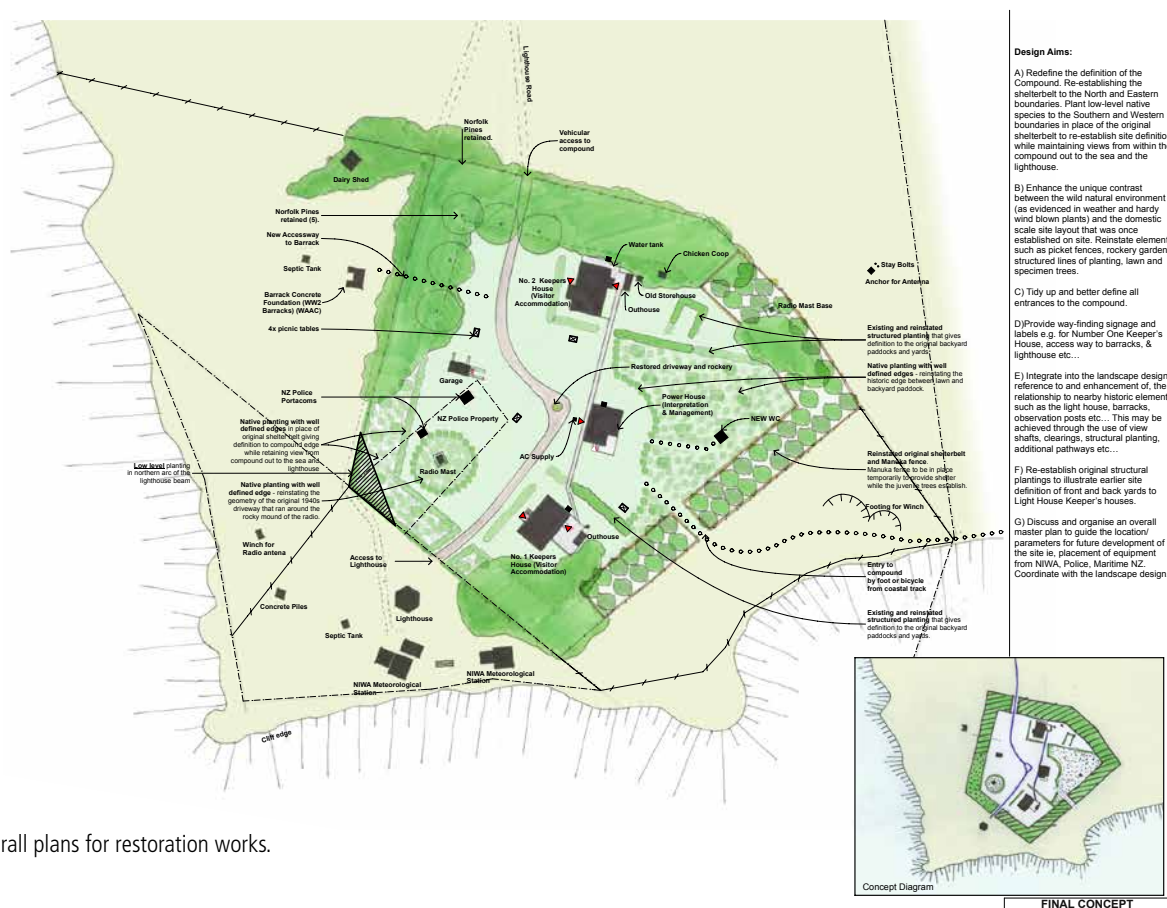

Overall plans for restoration works.

## How to get involved? Contact Friends of Baring Head

Visit  
[www.baringhead.org.nz](http://www.baringhead.org.nz)  
 or  
[www.gw.govt.nz](http://www.gw.govt.nz)

Contact Colin Ryder  
 rydercj@xtra.co.nz  
 ph 0210 383 655

Like us on facebook



greater WELLINGTON  
 REGIONAL COUNCIL  
 Te Pane Matua Taiao